

SECTION VII
HEAVY-DUTY ROLLER STOCK GUIDE

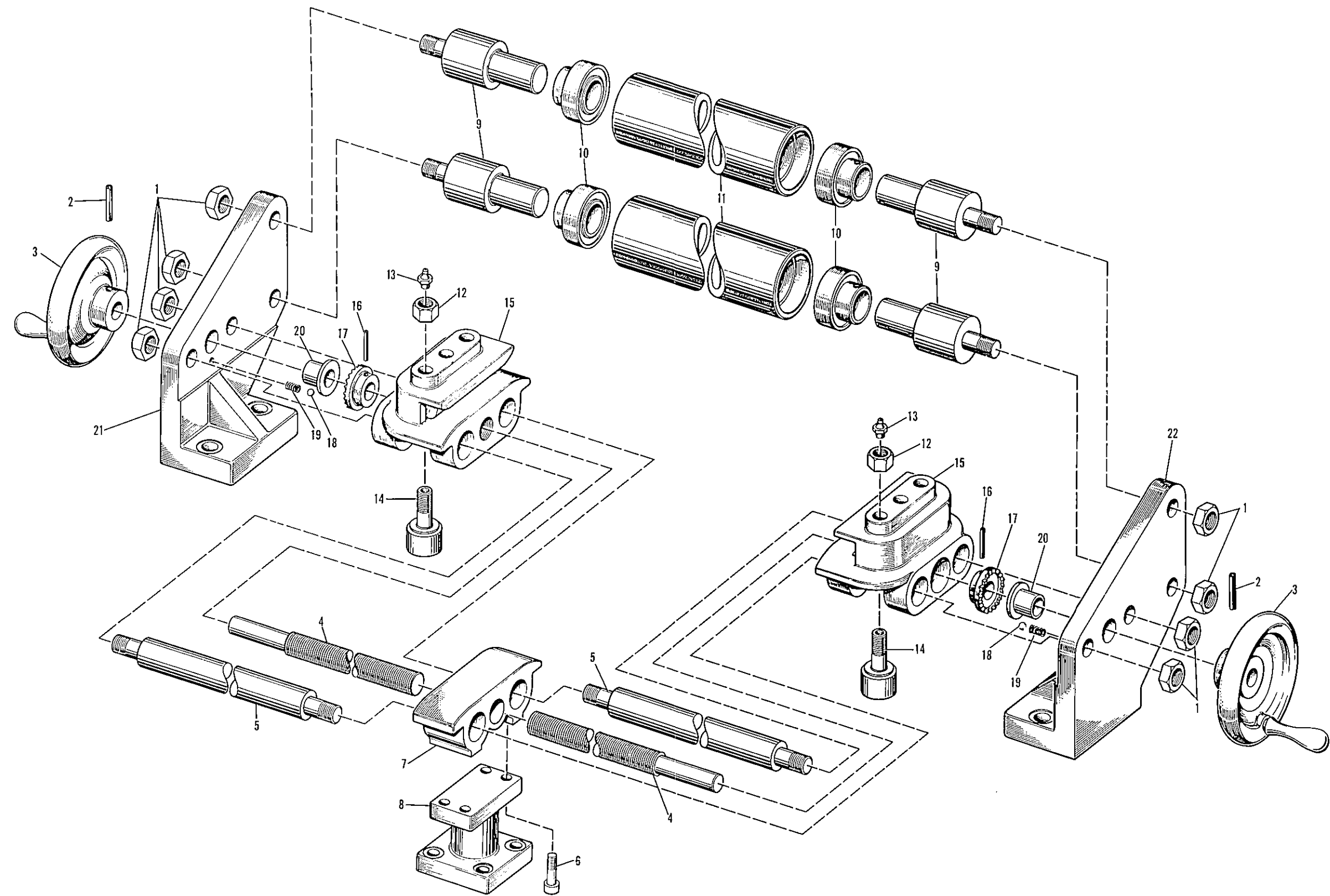

INDEX NO.	DESCRIPTION
1	Nut - Hex, Jam
2	Pin - Roll
3	Handwheel
4	Shaft - Adjusting Screw
5	Shaft - Stock Guide
6	Screw - Socket-head, Cap
7	Shoe - Stock Support
8	Support - Center Shoe
9	Stud - Guide Roll
10	Bearing - Ball
11	Roll - Guide

INDEX NO.	DESCRIPTION
12	Nut - Hex, Full
13	Fitting - Grease
14	Follower - Cam
15	Shoe - Stock Guide
16	Pin - Roll
17	Ratchet - Collar
18	Ball - Steel
19	Spring
20	Bushing - Flange
21	Bracket - Right-hand Stock Guide
22	Bracket - Left-hand Stock Guide

This is a heavy duty stock guide assembly used on the larger Littell units handling heavy stock.

CAUTION

A clearance of 1/32" over the width of the stock should be allowed, to provide free passage of the stock through the guides. If the stock binds at this point, it can produce short feed lengths in the die area.